

SEEDING BOOT SELECTION



PRIMARY
SALES AUSTRALIA

TO SUIT 32MM OD DELIVERY HOSE

SELECT BOOT



STANDARD FLEXI BOOT
ST-RFB-32MM \$39.50

LOW-MOUNT FLEXI BOOT
HOSE MOUNTS LOWER TO MATCH LONG POINTS AND AVOID BRACKET DAMAGE ON BREAKOUT
ST-RFB-LM-32MM \$44.00

SELECT TAIL



STRAIGHT TAIL (45MM LONG)
ST-RFBTAIL-45 \$17.00

CURVED TAIL
ST-RFBTAIL-C \$18.50

TOP SPIGOT OF FLEXIBOOT CAN BE SLEEVED TO SUIT SMALLER HOSE

TO SUIT 38MM OD DELIVERY HOSE

SELECT BOOT



LARGE FLEXI BOOT
ST-LRB-38MM \$42.00

LARGE FLOW-MOUNT FLEXI BOOT
HOSE MOUNTS LOWER TO MATCH LONG POINTS AND AVOID BRACKET DAMAGE ON BREAKOUT
ST-LRB-LM 38MM \$49.00

SELECT TAIL

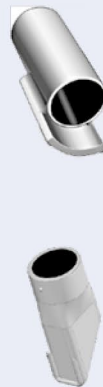

STRAIGHT TAIL (45MM LONG)
ST-LRBTAIL-45 \$15.75

STRAIGHT TAIL (25MM WIDE TAIL)
AS USED ON OUR PRECISION SEEDER BARS
P-ST-LRBTL-25 \$16.75



TAIL (65MM WIDE)
Not designed for use behind narrow points or in rocky conditions
SPLITTER
ST-LRBTAIL-Y \$29.00



CURVED TAIL
ST-LRBTAIL-C \$18.00

USE 2 OF 1" X 5/16" BOLTS AND NYLOCS TO MOUNT

ALL RUBBER FLEXIBOOTS ARE SUPPLIED WITH QUALITY STAINLESS HOSE CLAMPS

WARRANTY All rubber Flexiboots must have the delivery hose (or quality substitute nylon hose) fully inserted into boot for long life and accurate seed/fertiliser placement.



STEEL SEED BOOT RANGE

STEEL, HEIGHT AND ANGLE-ADJUSTABLE, FOR CLEAN CONDITIONS ONLY AND AVAILABLE TO SUIT 25, 32, 35, 38, 41 MM I/D HOSE.
Use with a pair of clips #ST CL-50 to angle tube back for shallow sowing.
ST-ADJ FROM \$39.00
CONNECTING LINKS TO ANGLE BOOT REARWARDS
***ST-CL-50 \$4.00**



RESIDUE DEFLECTORS

"TRASH TUBES"
MOUNTING BOLT & NYLOC NUT INCLUDED.
Please advise machine, tine and point type when ordering. On most models the lower end of the deflector is cut to fit over the top end of Primary points to eliminate another potential stubble trap. THEY ARE EASILY FITTED AND ARE ZINC COATED TO IMPROVE THEIR PERFORMANCE.
FOR "C" SHANK FLEXICOIL TINE ILLUSTRATED
TT-FC-350
PRICES FROM \$39.00

